

27,500 SF

Industrial Space For Lease



Prologis Park Kingsport



19613 81st Avenue South
Kent, Washington 98032 USA

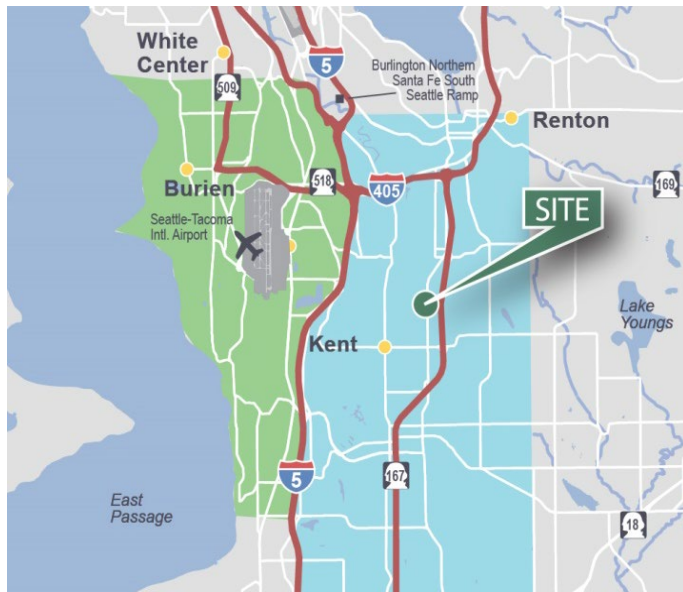

LOCATION

- Excellent North Kent Valley location
- Quick Access to SR-167 and I-5
- Prominent frontage on S. 196th St.

FACILITY

- ±27,500 square feet
- ± 996 square feet of office (Up to an additional ±8,732 SF of office available directly adjacent to the premises.)
- ± 20' clear height
- 4 dock-high doors
- 2 drive-in doors
- ± 100' deep x 275' wide
- ± 50' x 25' typical column spacing
- Upgraded sprinklers
- Available 6/1/2024

ADVANTAGES AND AMENITIES

- Access to the Prologis Essentials platform

Your single-source service for efficient move-in and operations: [prologisessentials.com](https://www.prologisessentials.com)

27,500 SF

Industrial Space For Lease



Prologis Park Kingsport

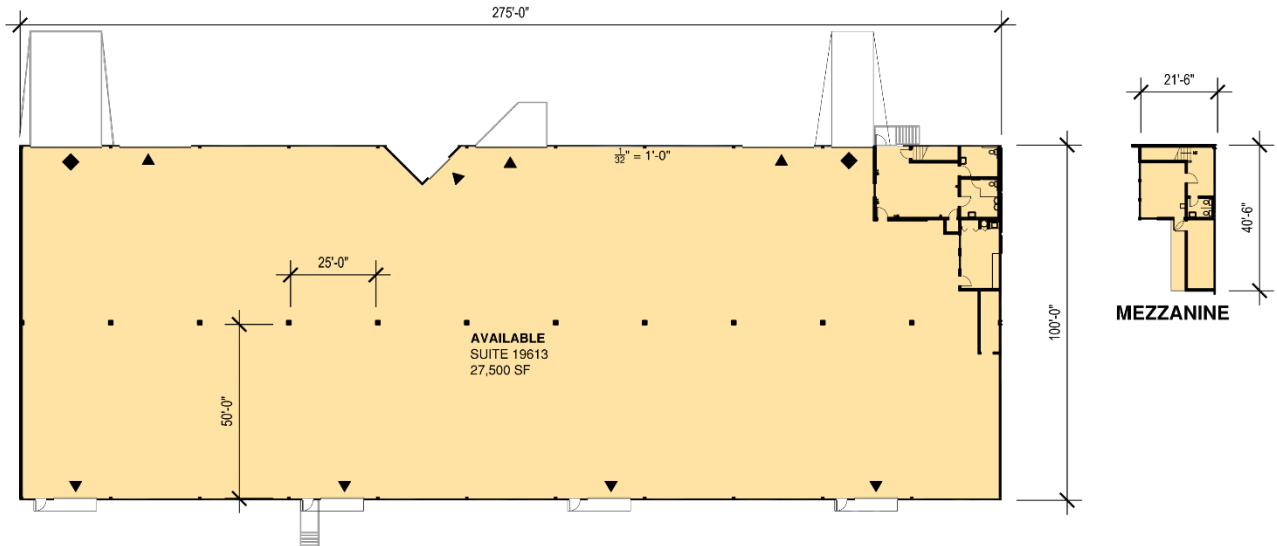

SUITE 19613

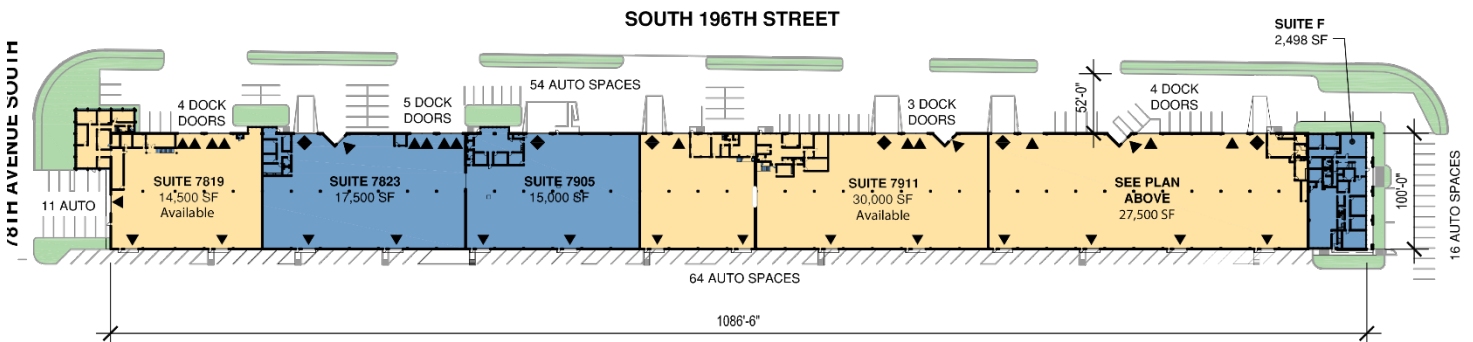

SITE PLAN
NTS



WA-REA

Wilma Warshak, SIOR
wilma.warshak@wa-rea.com
ph +1 206 838 5492
cell +1 206 409 1432
2371 Eastlake Ave. East
Suite 200
Seattle, WA 98102 USA

WA-REA

Alana Garrett
alana.garrett@wa-rea.com
ph +1 206 838 5492
cell +1 858 722 5627
2371 Eastlake Ave. East
Suite 200
Seattle, WA 98102 USA

WA-REA

Jackson Peterson
jackson.peterson@wa-rea.com
ph +1 206 838 5492
cell +1 503 739 1830
2371 Eastlake Ave. East
Suite 200
Seattle, WA 98102 USA

Prologis

Lucca Merlino
Lmerlino@prologis.com
ph +1 206 414 7621
cell +1 206 498 6511
5900 Airport Way South
Suite 300
Seattle, WA 98108 USA