

15,098 SF

Industrial Space For Lease



Prologis Park Seattle 18



5979 4th Ave S
Seattle, WA 98108 USA



LOCATION

- Excellent location; Minutes to Downtown Seattle & Port of Seattle.
- Quick access to I-5, Highway 99 & I-90.

FACILITY

- ± 15,098 SF
- ± 3,500 SF office space
- ± 3,975 SF mezzanine storage
- 3 dock doors
- 1 drive-in door
- 16 parking stalls
- Available January 2023

ADVANTAGES & AMENITIES

- Premiere street visibility along 4th Ave. South
- Abundant amenities in close proximity

Prologis Essentials: your single-source service for efficient move-in and operations at [prologisessentials](https://www.prologisessentials.com).

15,098 SF

Industrial Space For Lease



Prologis Park Seattle 18

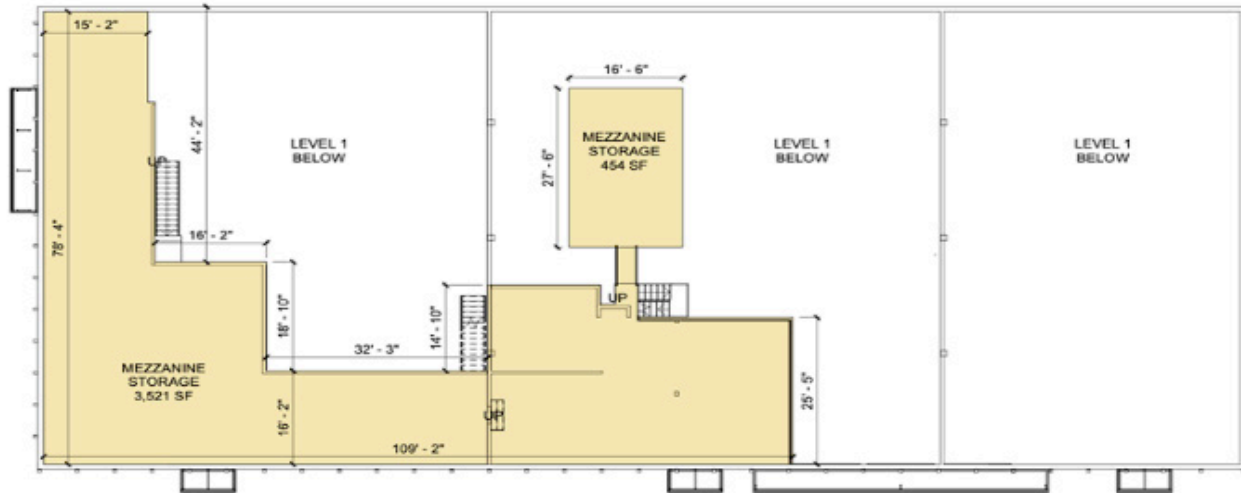
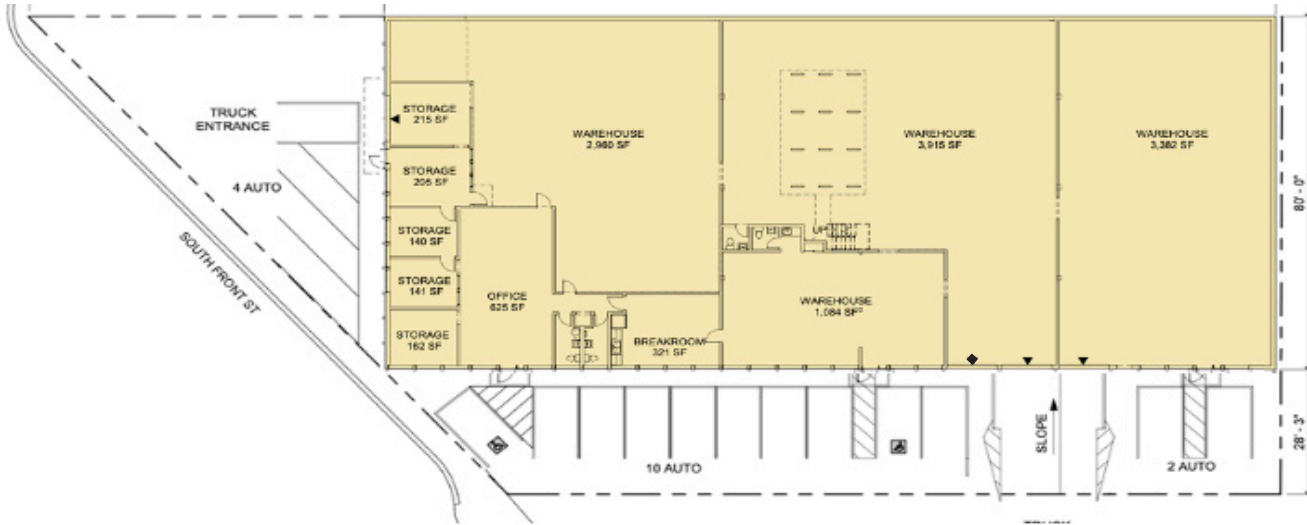

WA-REA
Wilma Warshak
wilma.warshak@wa-rea.com
ph +1 206 838 5492
cell +1 206 409 1432
2371 Eastlake Ave. E., Suite 200
Seattle, WA 98102 USA

WA-REA
Alana Garrett
alana.garrett@wa-rea.com
ph +1 206 838 5494
cell +1 858 722 5627
2371 Eastlake Ave. E., Suite 200
Seattle, WA 98102 USA

WA-REA
Jackson Peterson
jackson.peterson@wa-rea.com
ph +1 206 838 5493
2371 Eastlake Ave. E., Suite 200
Seattle, WA 98102 USA

Prologis
Richard Kolpa
RKolpa@prologis.com
ph +1 206 414 7610
cell +1 206 949 5681
5900 Airport Way. S.
Seattle, WA 98108 USA

Prologis Essentials: your single-source service for efficient move-in and operations at prologisessentials.

No warranty or representation, expressed or implied, is made as to the accuracy of the information contained herein, and same is submitted subject to error and omissions.